

Lion Gate Lodge

Floor Plan

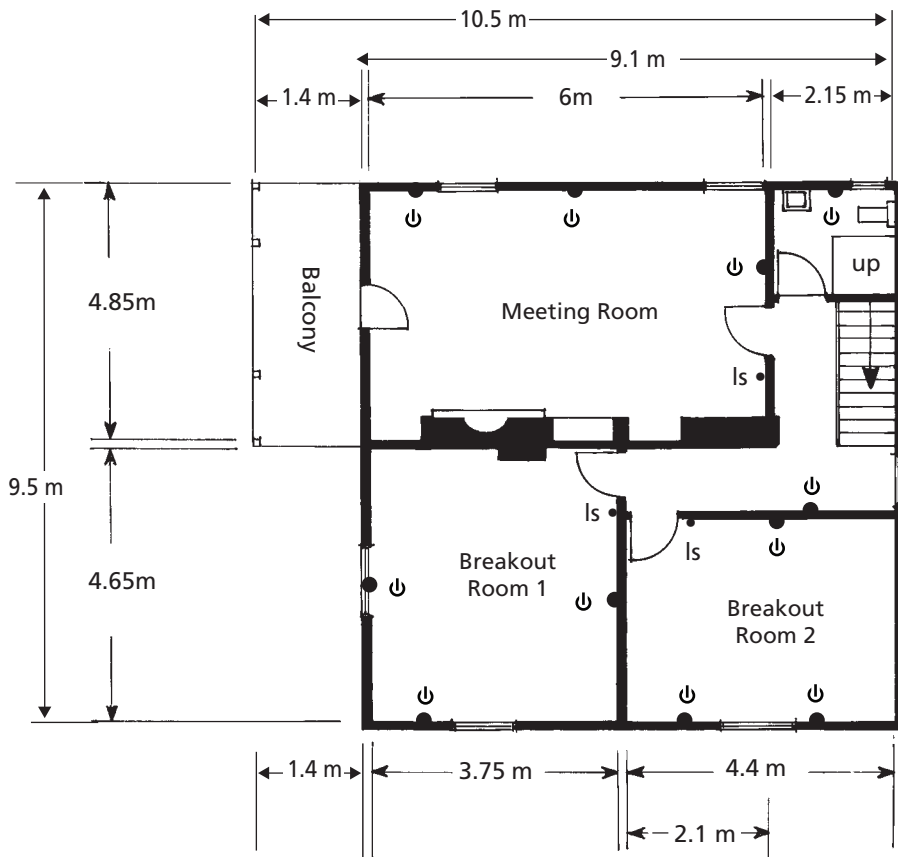

- ⏻ Power Point
- ⊠ External Lighting
- ls light switch
- vls verandah light switch
- x telephone

FIRST FLOOR
height to ceiling:
3.05 m

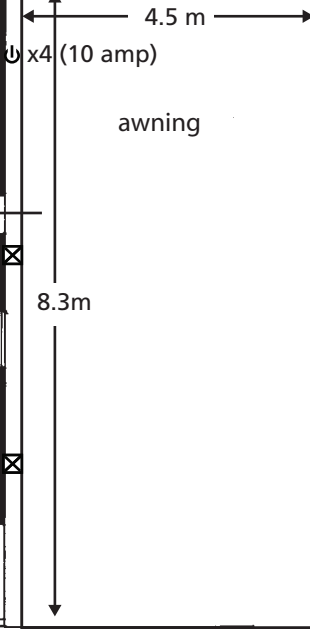
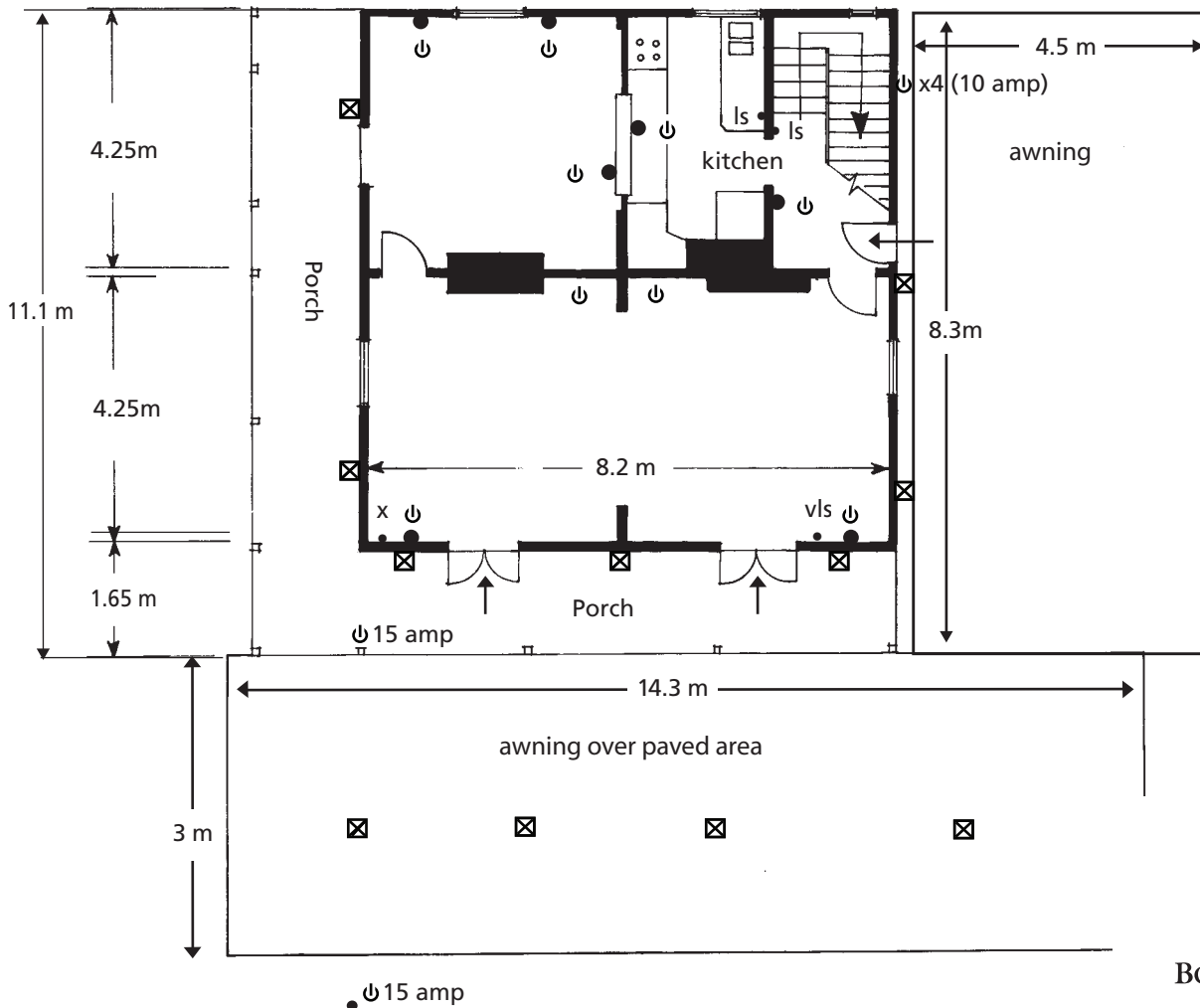

GROUND FLOOR
height to ceiling:
3.25 m
floor to picture
rail 3.14 m

